



THE DELHI MALL

NEW DELHI





The Delhi Mall, part of Leela Sky Villas, Navin Minar, The tallest planned tower of Delhi, more than 2.5 times taller than Qutub Minar

First mix use development in New Delhi with step in Shopping Mall, Food Courts, Showrooms, Offices, Movies for a lifestyle living (with multi-level lift parking).

The overall development will be over 5 acres out of which approximately 2 acres footprint will be under the mall.

The Delhi Mall, Delhi will be a Premium Brands only Mall, obviously, with a few firsts to its name.

9 Screen INOX Multiplex.

With G,1,2 floors reserved for Luxury Retail, 3rd floor for Food Court & Entertainment, 4th floor for Halls, 5th floor for Pubs/Brewery & 6th-10th floor for Boutique Luxury Showrooms (with attached multi-level car parking) this will be the most happening place in Central and West Delhi.

It will offer a lifestyle yet unseen in Delhi NCR where shopping sprees, Movie watching delight, or Food binging urges can all be catered to the heart of Delhi.

Proposed Zoning in Floor Plan

Ground Floor

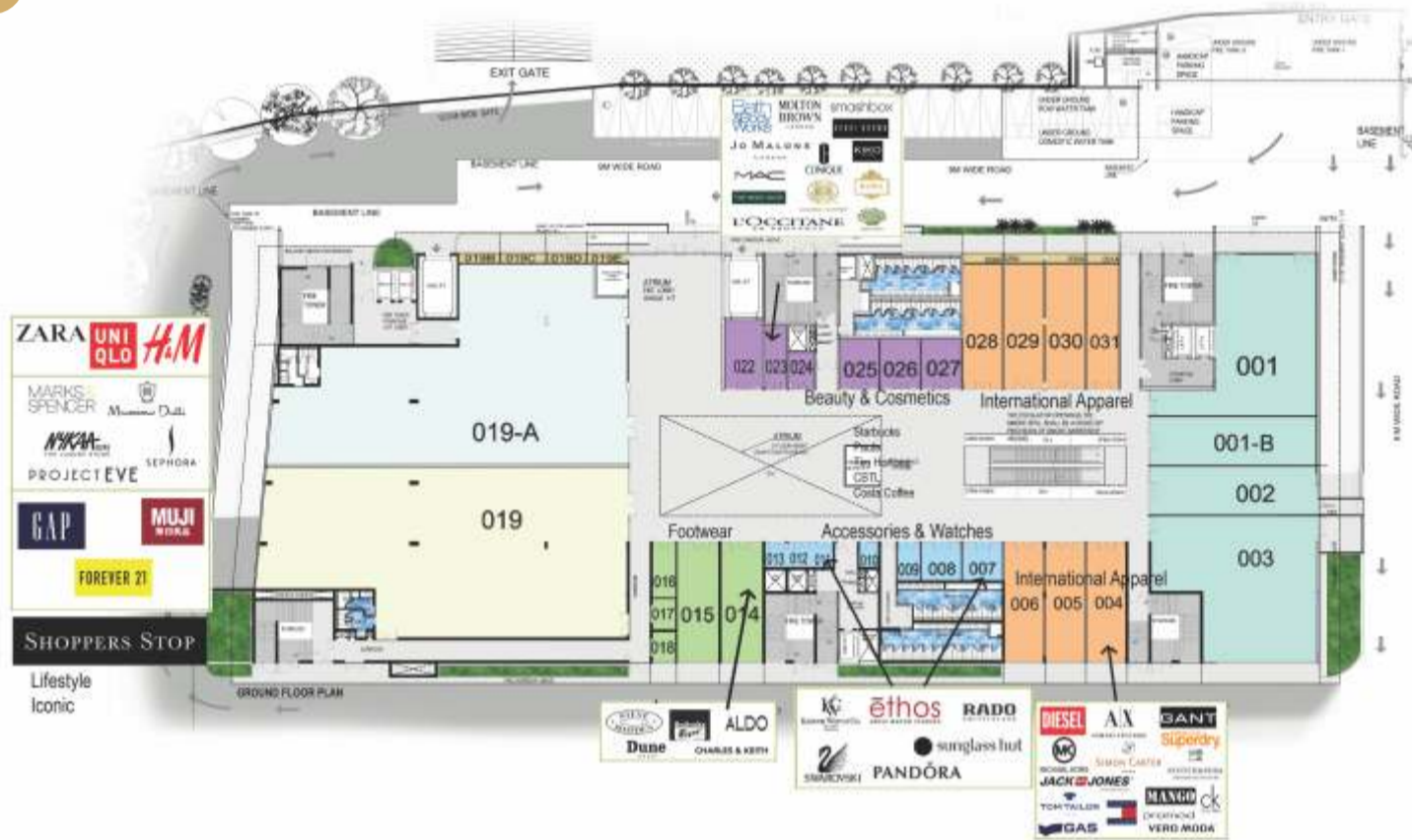

First Floor



Second Floor



Electronics MBO Supermarket

Third Floor



RESTAURANT/
FOOD COURT/
CHILDREN TOY STORE

Big Chill
Cafe Delhi Heights
Johney Rockets
Bikanerwala

Site Plan



RESIDENTIAL CATCHMENT

Some prominent residential areas

(Within a radius of 3 km & a drive time of up to 10 minutes)

- Karol Bagh
- Punjabi Bagh
- Kirti Nagar
- Naraina Vihar
- Patel Nagar
- Rajinder Nagar
- Moti Nagar
- Karam Pura

(Within a radius of 5 km & a drive time of up to 15 minutes)

- Paschim Vihar
- Janak Puri
- Civil Lines
- Ashok Vihar
- Shalimar Bagh
- Rohini
- Tagore Garden
- Maya Puri
- Hari Nagar
- Gole Market
- President Estate
- Chanakya Puri
- Shalimar Bagh
- Rani Bagh

(Within a radius of 10 km & a drive time of up to 30 minutes)

- Sunder Nagar
- IGI Airport
- Vasant Vihar
- Vasant Kunj
- R. K. Puram
- Munirka
- Moti Bagh
- Dwarka
- Safdarjung Enclave
- Jor Bagh
- Sarojini Nagar
- Kamla Nagar
- Model Town
- Shalimar Bagh
- Rohini
- Lodhi Colony

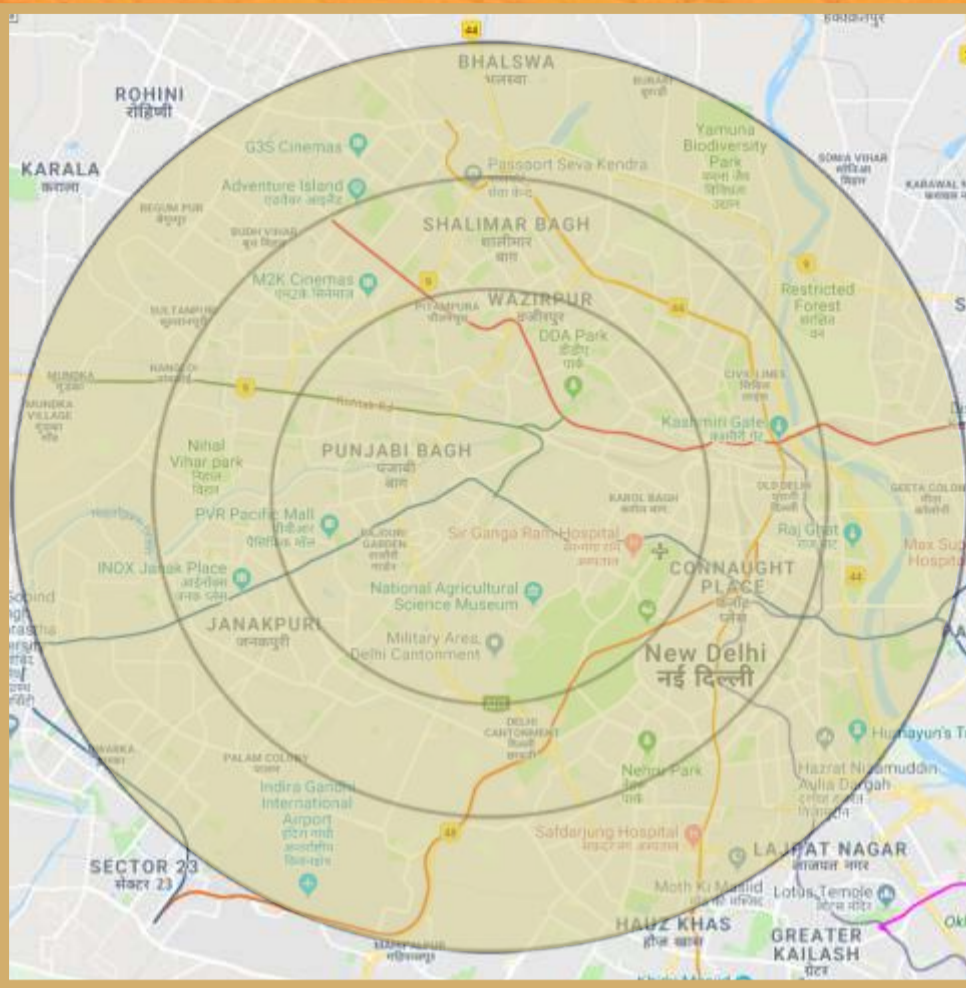

The Best Locality

- | | | |
|----|--------------------|--------|
| 1 | Rashtrapati Bhawan | 5.0 km |
| 2 | India Gate | 8.3 km |
| 3 | South Block | 6.3 km |
| 4 | Connaught Place | 6.2 km |
| 5 | RML Hospital | 5.1 km |
| 6 | Rajendra Place | 2.2 km |
| 7 | Dhaura Kuan | 5.7 km |
| 8 | ITC Maurya Hotel | 6.1 km |
| 9 | Taj Palace Hotel | 6.2 km |
| 10 | Taj Mughal Hotel | 8.3 km |

- | | | |
|----|--|--------|
| 11 | Khan Market | 8.7 km |
| 12 | Aurangzeb Road
(Dr. APJ Abdul Kalam Road) | 7.9 km |
| 13 | Prithvi Raj Road | 8.3 km |
| 14 | Firozshah Road | 7.5 km |
| 15 | Janpath | 7.2 km |
| 16 | Baba Kharag Singh Marg | 5.4 km |
| 17 | Bangla Sahib | 5.7 km |
| 18 | Mother Teresa Crescent | 5.8 km |
| 19 | Chanakya Puri | 6.9 km |
| 20 | Ashoka Hotel | 7.5 km |

- | | | |
|----|---------------------|--------|
| 21 | Dhaura Kuan Club | 5.1 km |
| 22 | Lalit Hotel | 7.3 km |
| 23 | B.L.K. Hospital | 2.4 km |
| 24 | Ganga Ram Hospital | 3.5 km |
| 25 | Modern School | 7.3 km |
| 26 | St. Columbus School | 5.3 km |
| 27 | Airport | 9.2 km |
| 28 | Ridge Area | 2.7 km |
| 29 | Pusa | 0.2 km |
| 30 | Ring Road | 2.3 km |
| 31 | The Leela Palace | 8.6 km |

Distance from THE DELHI MALL Approx in K.M.

